

**Stair Section Detail**  
 3/8" = 1'-0"

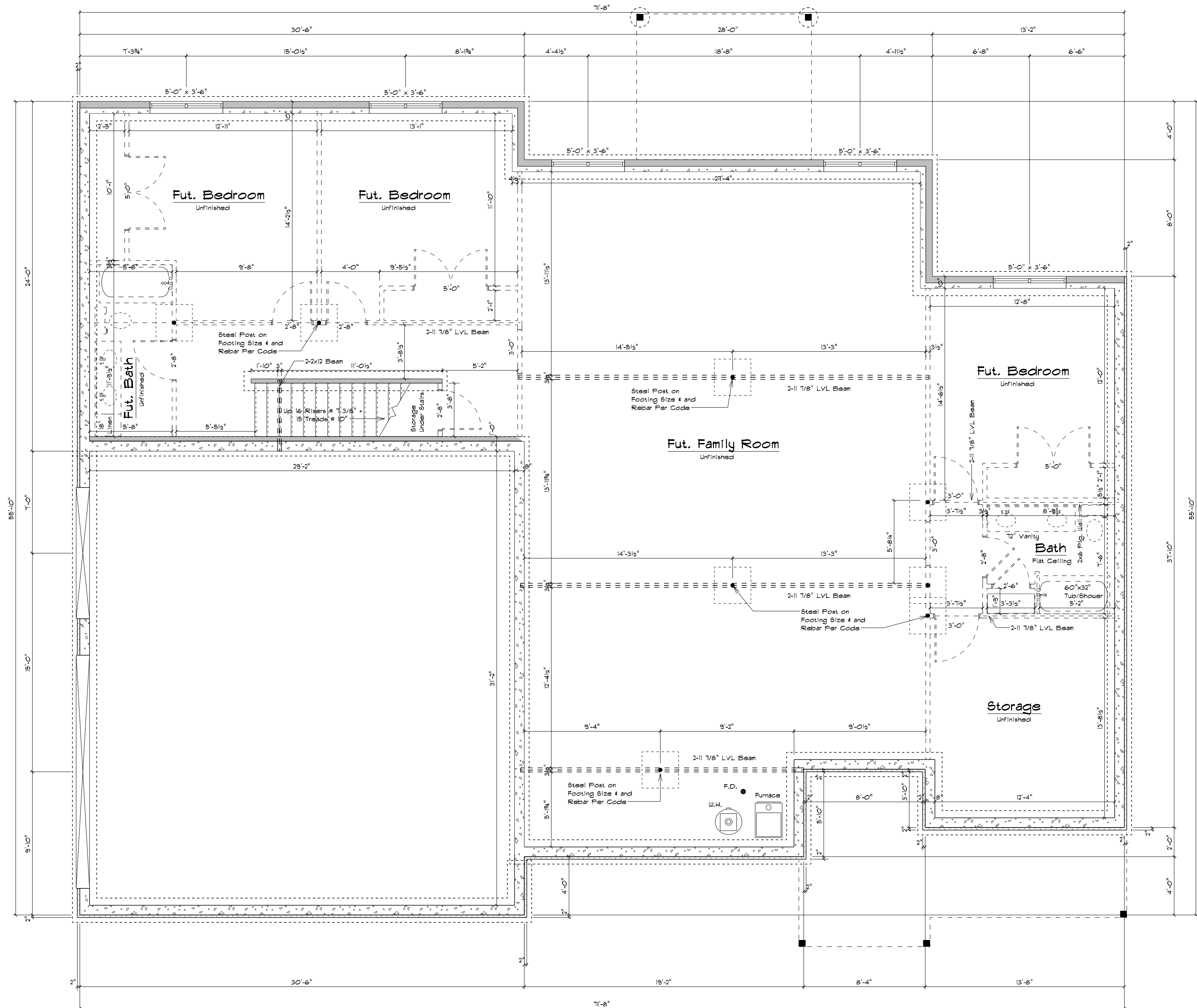

**Basement Floor Plan**  
 2550 Sq. Ft. 1/4" = 1'-0"

- Notes:
- All exterior walls are constructed as noted.
  - All interior walls are 2x4 studs at 16" o.c., unless otherwise noted.
  - Interior dashed walls are future finish.
  - All interior dimensions are surface of stud to surface of stud.
  - All openings are nominal, rough openings per window and door manufacturers.

These plans have been prepared using information provided by the purchaser, who is solely responsible for the accuracy of that information. It is the responsibility of the purchaser and/or general contractor to insure that the structure is built in compliance with all local building codes. Your local building codes may require these plans to be amended to meet local requirements. The purchaser and/or general contractor shall be responsible for the accuracy of these plans to avoid mistakes, the designer cannot guarantee against human error. The general contractor on the job must check all dimensions, window sizes (including egress), and other details and be responsible for the same. The purchaser releases Advanced Home Design from any claims or lawsuits that may arise during construction.

**Advanced Home Design, LLC**  
 Phone (605) 787-6897  
 Cell (605) 484-1202  
 jacued2@gmail.com

**Paddlefish Partners II**  
**Pheasant Run Rancher**  
 Michael Litt (917) 496-7118  
 Joe Lafave (606) 282-3005

Plan No. R-010519  
 Drawn By Jack Luedjckewski  
 Date July 23, 2019  
 Rev. Date